

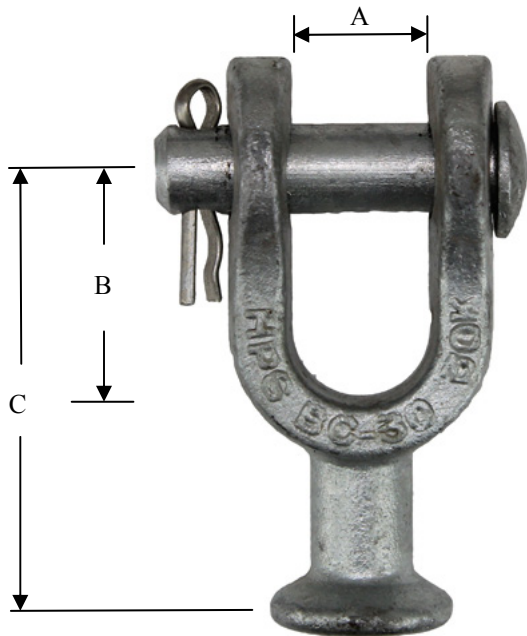

Quincaillerie / Hardware

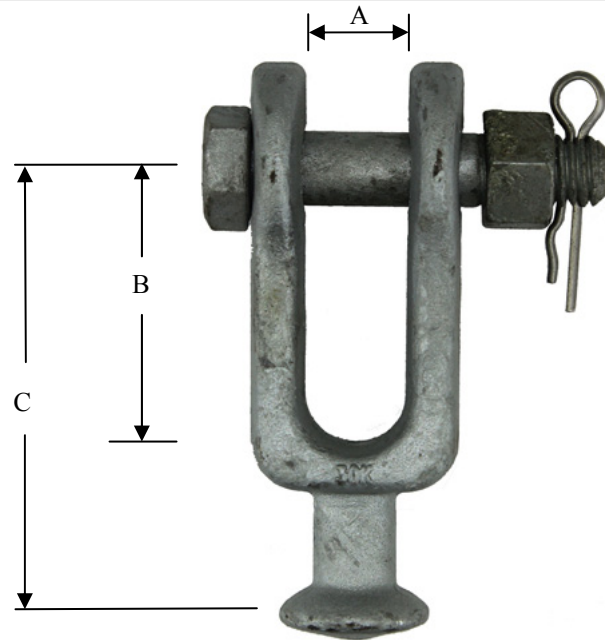

3934



3934-1
60155E
3934-1-E6

Numéro de catalogue Catalog number	A		B		C		Diamètre du boulon Bolt Size		Classe d'isolateur Insulator class	Force minimum calculée Min. Rated Strength		Poids (lbs) Weight (lbs)
	po. in.	cm	po. in.	cm	po. in.	cm	po. in.	cm		lbs.	KN	
	3934	13/16	2.06	1 9/16	3.97	3	7.62	5/8		1.59	52-3 & 52-5	
3934-1	13/16	2.06	1 9/16	3.97	3	7.62	5/8	1.59	52-3 & 52-5	35,000	156	1.1
60155E	13/16	2.06	2 5/16	5.87	3 3/4	9.53	5/8	1.59	52-3 & 52-5	35,000	156	1.1
3934-1-E6	13/16	2.06	1 9/16	3.97	3	7.62	3/4	1.91	52-3 & 52-5	35,000	156	1.1

Matériel: Acier Galvanisé
Material: Galvanized steel

Note: Autres dimensions disponible / Other sizes available

MANILLE À ROTULE / BALL CLEVIS